



Features

- Parker DM Series offer double shut-off valving and push-to-connect operation in a small envelope size.
- They are constructed of nickel plated brass and are available in 1/8" body size only.
- Standard seals are Viton, but other seal material is available upon request. See the Coupling Selection and Ordering Information Guide at the beginning of Section A and the Fluid Compatibility Chart at the end of this catalog for optional materials.

Performance

Air Pressure Drop
1/8" DM Series

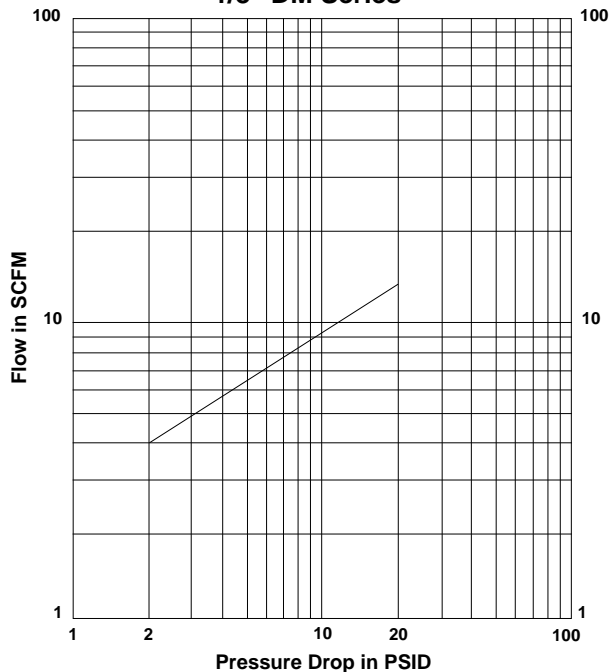

Water Pressure Drop
1/8" DM Series

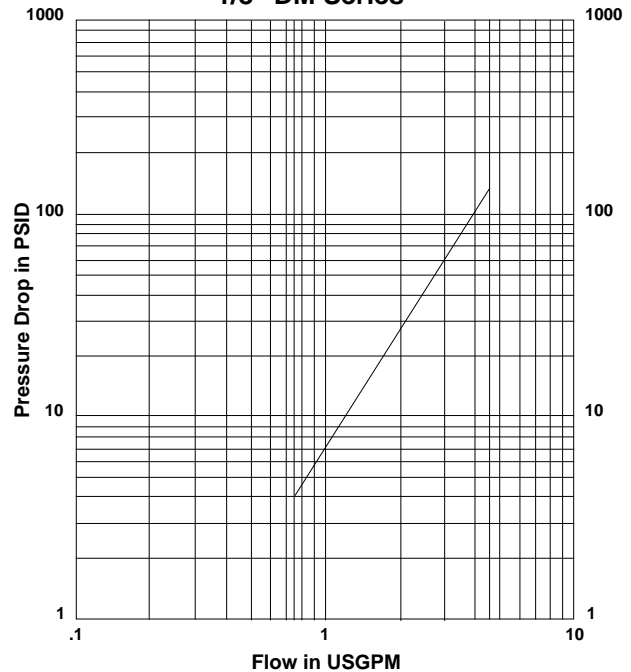

Applications

Typical applications dental equipment, lubrication equipment, fluid transfer and coolant lines.

Specifications

Body Size (in.)	1/8"
Temperature Range	-15°F to +390°F
Rated Pressure	250 PSI
Locking Device	5 Balls
Rated Flow (GPM)	0.8

How To Order

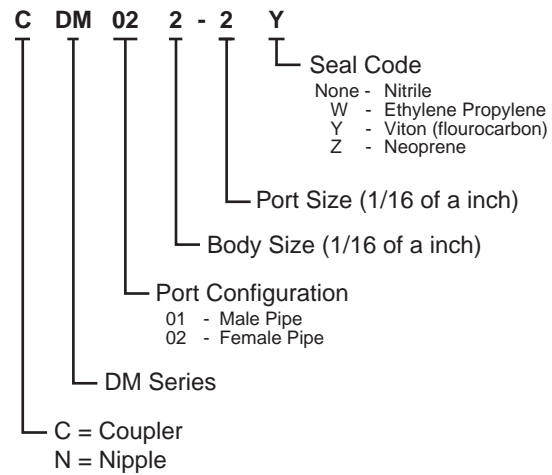

Pneumatic Quick Couplings

Double Shut-Off Couplings

DM Series

Couplers

Female Pipe Thread

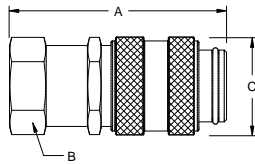

Body Size (in.)	Part Number Brass	Thread Size NPTF	Dimensions (in.)			Wt. (LB) P/Price
			Overall Length	Hex Size	Largest Diameter	
			A	B	C	
1/8	CDM02-2-2Y	1/8-27	1.42	0.55	0.63	.06
1/8	CDM02-2-4Y	1/4-18	1.81	0.67	0.78	.10

Male Pipe Thread

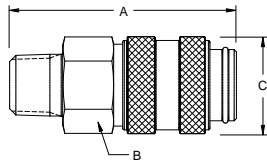

Body Size (in.)	Part Number Brass	Thread Size NPTF	Dimensions (in.)			Wt. (LB) P/Price
			Overall Length	Hex Size	Largest Diameter	
			A	B	C	
1/8	CDM01-2-2Y	1/8-27	1.50	0.55	0.63	.06
1/8	CDM01-2-4Y	1/4-18	1.61	0.55	0.63	.07

Nipples

Female Pipe Thread

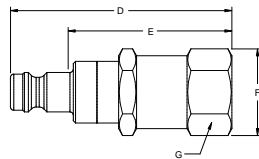

Body Size (in.)	Part Number Brass	Thread Size NPTF	Dimensions (in.)			
			Overall Length	Exposed Length*	Hex Size	Largest Diameter
			D	E	F	G
1/8	NDM02-2-2Y	1/8-27	1.56	1.03	0.55	0.63
1/8	NDM02-2-4Y	1/4-18	1.97	1.44	0.67	0.78

* This dimension represents the portion that is exposed when a nipple is inserted into a Parker DM Series coupler.

Male Pipe Thread

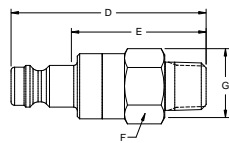

Body Size (in.)	Part Number Brass	Thread Size NPTF	Dimensions (in.)			
			Overall Length	Exposed Length*	Hex Size	Largest Diameter
			D	E	F	G
1/8	NDM01-2-2Y	1/8-27	1.65	1.12	0.55	0.63
1/8	NDM01-2-4Y	1/4-18	1.77	1.24	0.55	0.63

* This dimension represents the portion that is exposed when a nipple is inserted into a Parker DM Series coupler.

Pneumatic Quick Couplings

Grip-Ring Sleeve



Features

- This Grip-Ring sleeve enables the operator to connect or disconnect the coupling easily, even with greasy hands or while wearing heavy gloves.
- Grip-Ring sleeves are available for all 10 and 20 Series couplers. To specify a model with a Grip-Ring sleeve, add the suffix letter "R" to the regular model number. Example: B13R.

Caution: The Grip-Ring sleeve is subject to unintended disconnect if dragged on the end of a hose. Do not attempt to pull it over obstacles.

Accessories

Coupler Options

Sleeve-Lok



Features

- All sizes of 10, 20, 30, 50, and 70 Series couplers can be furnished with Locking Sleeves, as illustrated.
- Place suffix letters "-SL" (Sleeve-Lok) after regular catalog number. Example: B13-SL.

Pneumatic Quick Couplings

Ordering Information

When ordering Parker coupler bodies and nipples, please state the part number of each type of coupler body and each type of nipple desired. List coupler bodies and nipples as separate items rather than in combinations. Be sure to double check thread or hose sizes of items required.

Many of Parker's coupling products are available with unique non-standard options well suited to very specific applications. Examples of unusual end use applications might include: high temperatures (above 250° F), extremely caustic/corrosive solutions passing through the coupling, external/environmental corrosion situations, or other high wear and tear situations such as dragging the product along the ground. It is always recommended that the Quick Coupling Division be contacted with any questions concerning specific product application needs.

Typically, a prefix or suffix is added to the base part number to specify a non-standard O-ring seal, or special option such as a sleeve lock. The list at right illustrates the designations.

Please Note: Certain couplings series have additional "Special Order Information" which should be referred to in ordering those products. If applicable to the product, "Special Order Information" is found next to the Features and Specifications charts.

Ordering Information

Coupling Material

Coupler

- Prefix "B" for Brass - available for 3/8 & 1/2" body sizes only
- Suffix "N" for Stainless Steel springs, locking balls and brass valves. (10, 20, 30, 50, and 70 series only)

Nipple

- Prefix "B" for Brass (Standard material is steel)

Seals*	Material	Suffix
Standard	Buna-N	none
Optional	Ethylene Propylene	W
Optional	Viton	Y

Operation

- Suffix "SL" for coupler sleeve-lok (10, 20, 50, and 70 series only)
- Suffix "R" for grip-ring sleeve (10 and 20 series only)

*To select proper seal materials, see Fluid Compatibility Chart in Appendices section, or contact your Parker Quick Coupling Distributor.